

APPLIED ON NAILING FIN (FACTORY APPLIED)

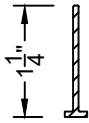

SLIDE ON NAILING FIN
AVAILABLE FOR
SERIES 100 ONLY

FILL VOID WITH
GLAZING TAPE
& SEALANT
IN FACTORY

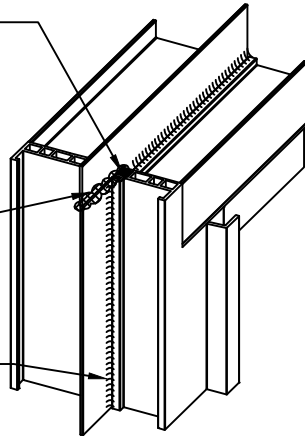

APPLIED SEALANT
AT JOINT AREA BY
WINDOW INSTALLER
IN FIELD

CAP BEAD
SEALANT ON
BOTH SIDE
IN FACTORY

SERIES 100

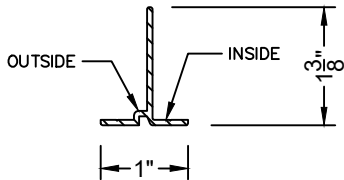
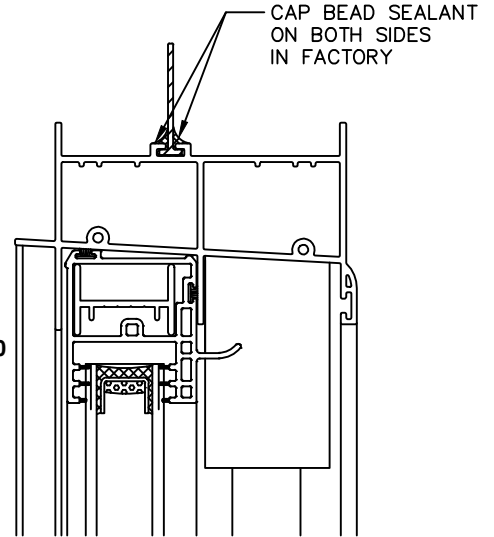

APPLIED SEALANT
AT JOINT AREA BY
WINDOW INSTALLER
IN FIELD

CONTINUOUS BED OF
SEALANT BEFORE APPLY
NAILING FIN
IN FACTORY

STAINLESS FLAT HEAD
VINYL HOLD TAPING SCREW,
#8X $\frac{1}{2}$ " , 4" O.C.)

SERIES 200

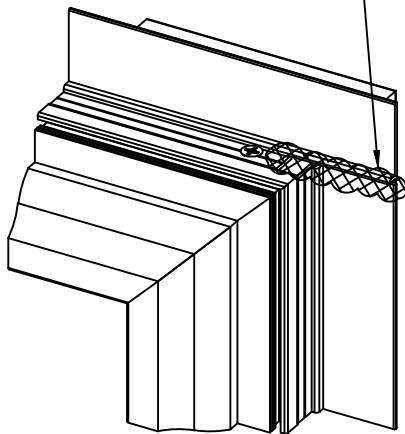
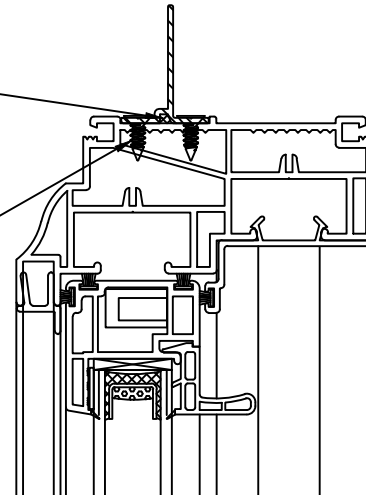

CONTINUOUS BED OF
SEALANT BEFORE APPLY
NAILING FIN
IN FACTORY

STAINLESS FLAT HEAD
VINYL HOLD TAPING SCREW,
#8X $\frac{1}{2}$ " , 4" O.C.)

SERIES 500

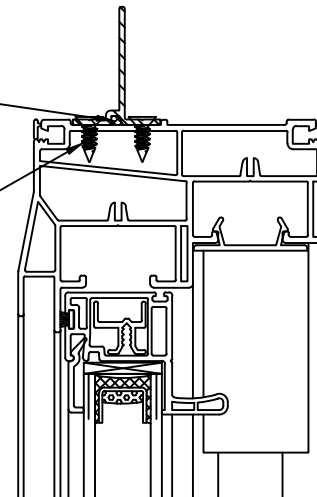

APPLIED ON J CHANNEL (FACTORY APPLIED)

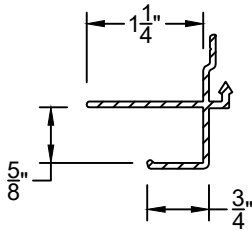

APPLIED ON J CHANNEL WITH
NAILING FIN (45° CUT)
AVAILABLE FOR SERIES 200 & 500

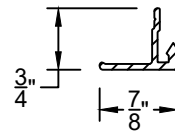

J CHANNEL (45° CUT)
AVAILABLE
FOR SERIES 300

CONTINUOUS BED OF
SEALANT BEFORE
APPLY NAILING FIN
IN FACTORY

STAINLESS FLAT HEAD
VINYL HOLD TAPING
SCREW,
#8X $\frac{1}{2}$ " 4" O.C.)

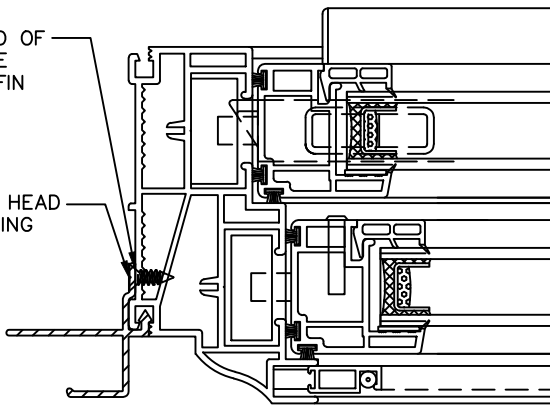

SERIES 200

CONTINUOUS BED
OF SEALANT
BEFORE APPLY
NAILING FIN
BY WINDOW
INSTALLER IN
FIELD

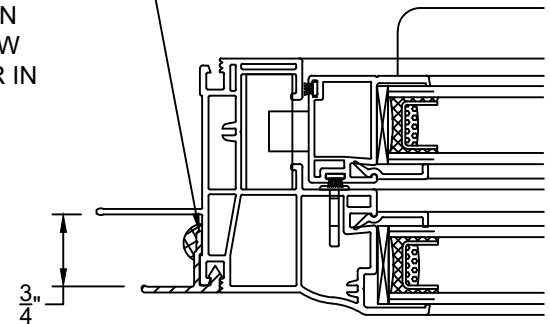

SERIES 300

CONTINUOUS BED OF
SEALANT BEFORE APPLY
NAILING FIN
IN FACTORY

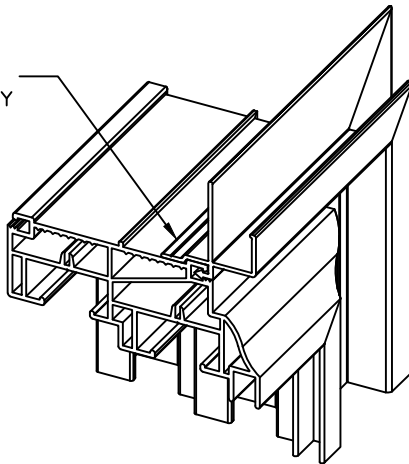

CONTINUOUS BED
OF SEALANT
BEFORE APPLY
NAILING FIN
BY WINDOW
INSTALLER IN
FIELD

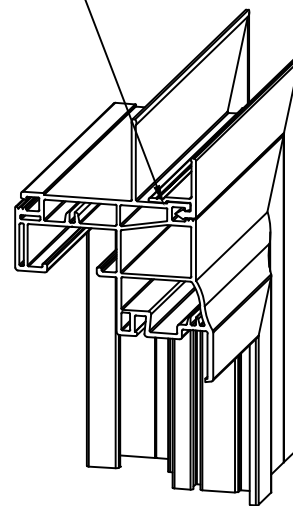

MULLION (FACTORY MULL)

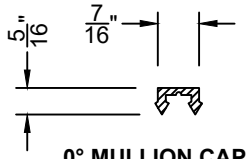

0° MULLION CAP
For Series
200, 300, 400, 500

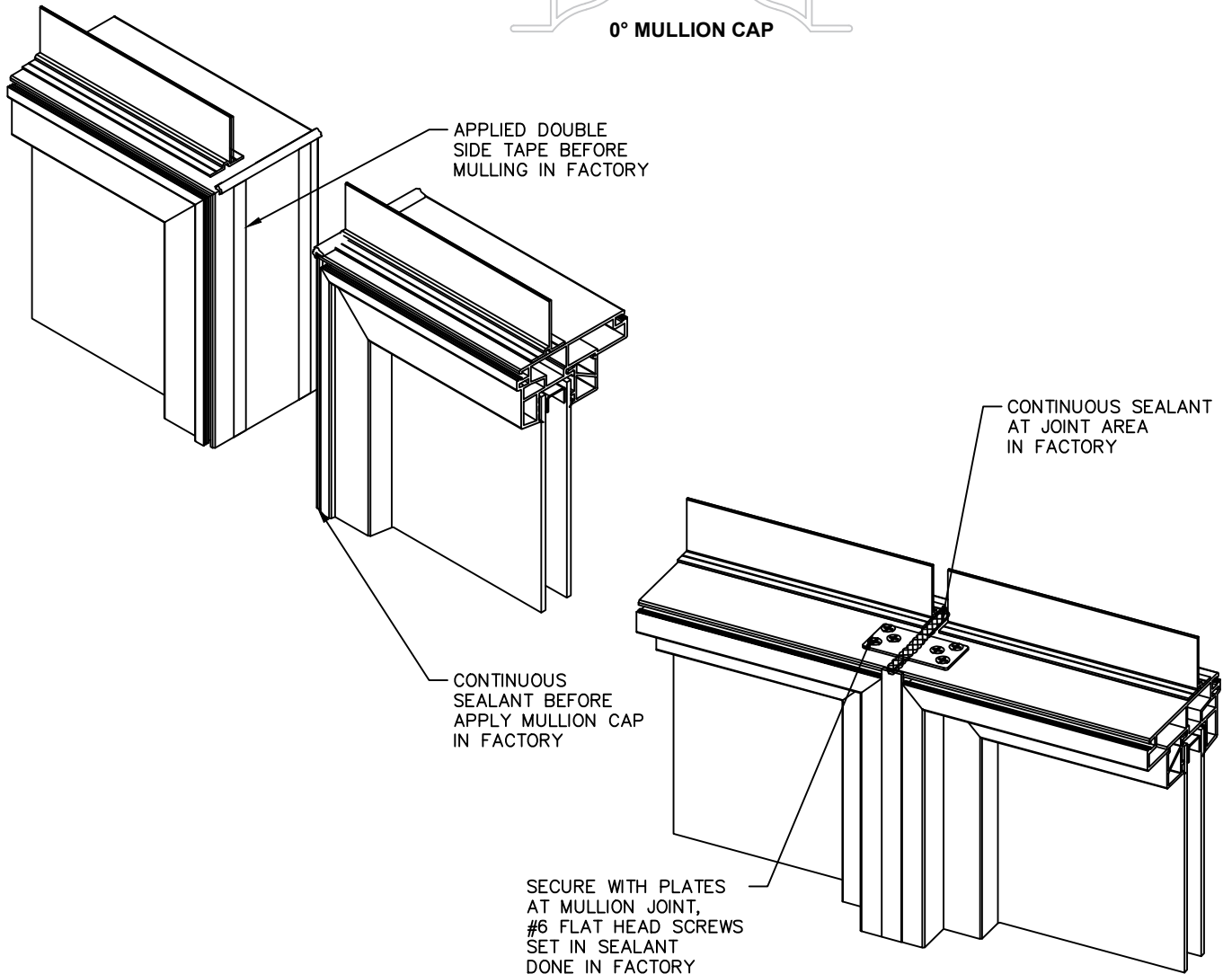
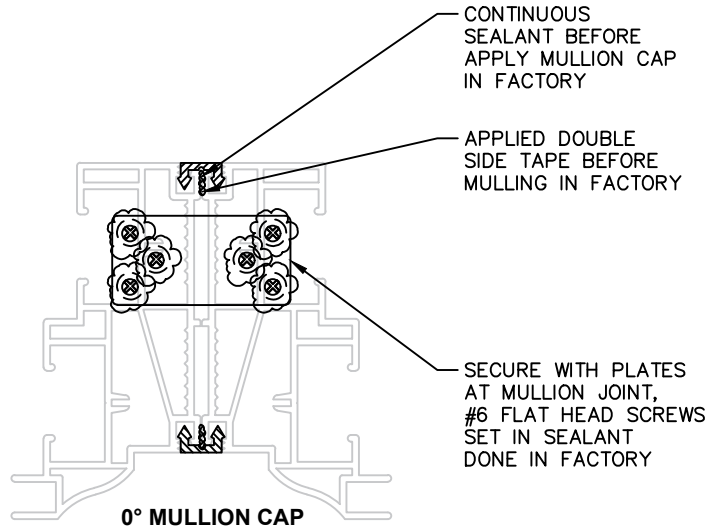

BAY & BOW (FACTORY MULL)

