

340 HOPPER DOWN

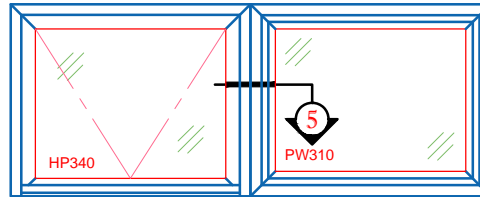

340 HOPPER DOWN & PW 310

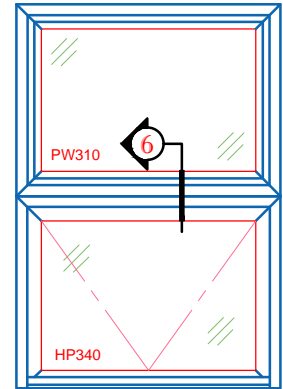

PW310 OVER HP340

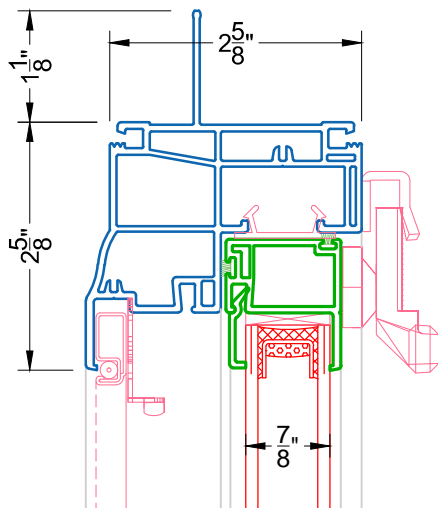

1 STANDARD HEAD
 340 HOPPER DOWN

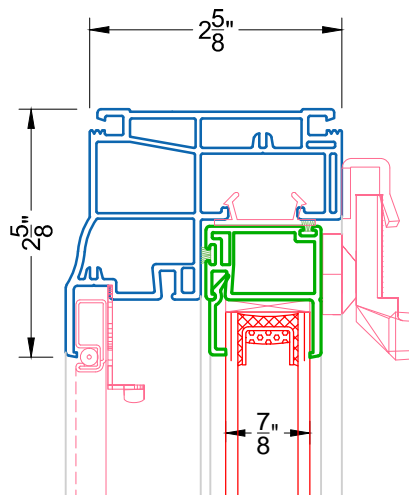

1A HEAD W/O NAILING FIN
 340 HOPPER DOWN
 FOR REPLACEMENT
 CONSTRUCTION
 OR MULLED UNIT

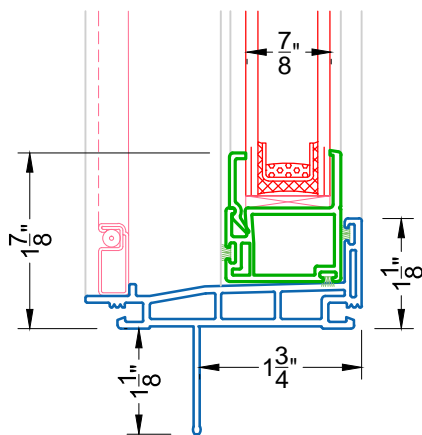

2 STANDARD SILL
 340 HOPPER DOWN

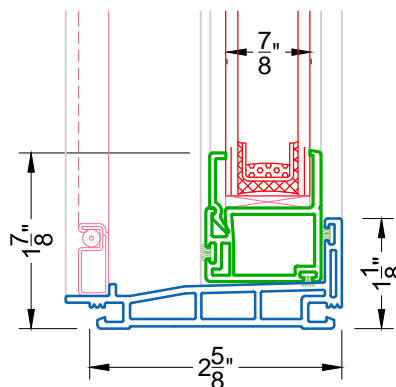

2A SILL W/O NAILING FIN
 340 HOPPER DOWN
 FOR REPLACEMENT
 CONSTRUCTION
 OR MULLED UNIT

FEATURES

- 2 5/8" FRAME DEPTH
- 7/8" INSULATED GLASS
- SOFT COAT LOW-E & ARGON FILLED IGU
- STAINLESS STEEL HINGES
- FUSION WELDED FRAME & SASHES
- CONTINUOUS POLYETHYLENE RIGID SEAL
- TWO PIECE CAM TURN HANDLE
- INTEGRAL NAILING FIN

OPTIONAL

- TRIPLE-GLAZED INSULATED GLASS UNIT
- PERFORMA TCTM HIGH PERFORMANCE LOW-E UPGRADE
- BETWEEN THE GLASS OR EXTERIOR APPLIED GRIDS
- PAINTED EXTERIOR CUSTOM COLOR
- EXTRUDED BEIGE COLOR
- DURALITE[®] SPACER

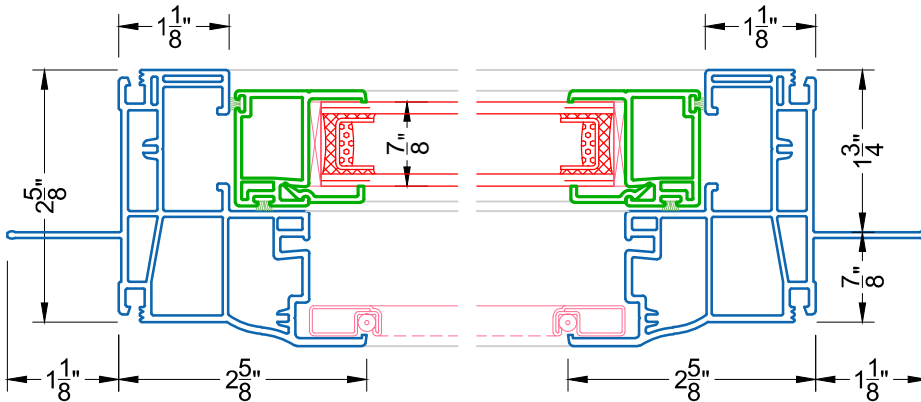

3 STANDARD JAMB
 340 HOPPER DOWN

4 STANDARD JAMB
 340 HOPPER DOWN

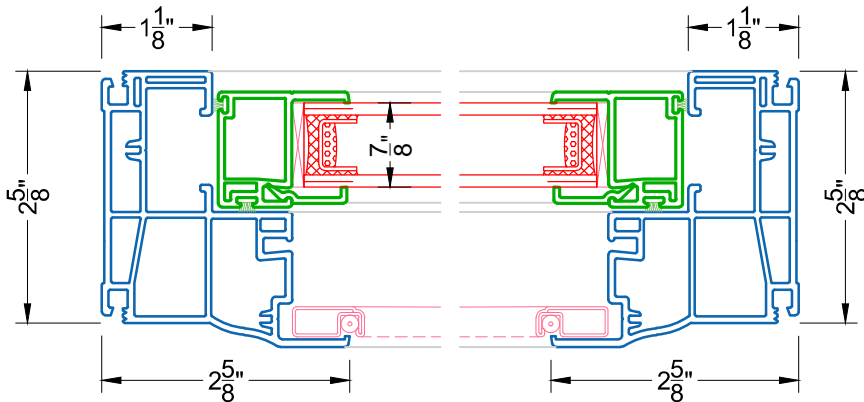

3A JAMB W/O NAILING FIN
 340 HOPPER DOWN
 FOR REPLACEMENT
 CONSTRUCTION
 OR MULLED UNIT

4A JAMB
 340 HOPPER DOWN
 FOR REPLACEMENT
 CONSTRUCTION
 OR MULLED UNIT

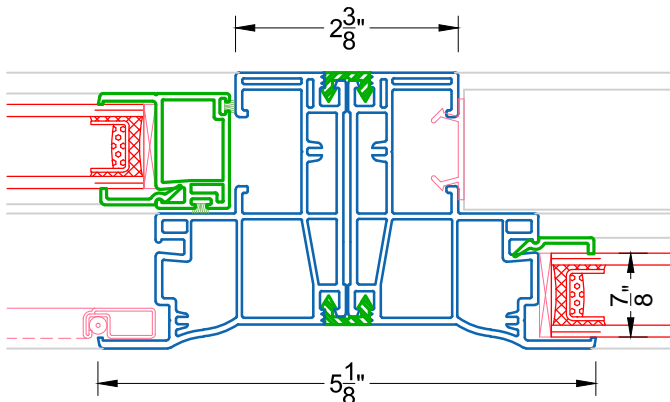

5 0 DEGREE MULLION
 HP 340 & PW 310

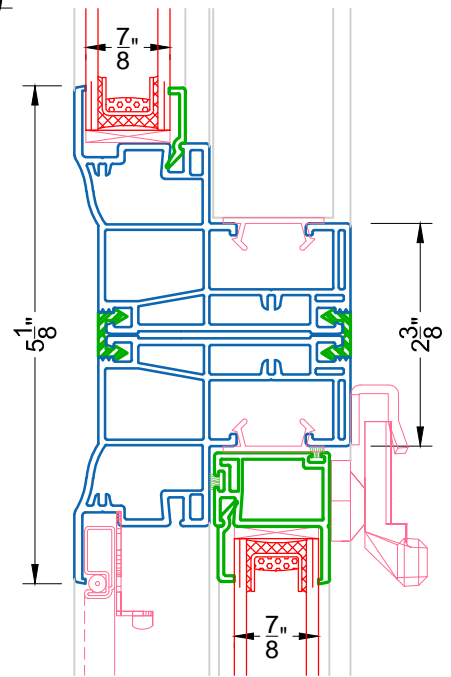

6 0 DEGREE MULLION
 PW 310 OVER HP 340