

Series 1500



Features

- **Frame Depth = 4⁵/₈"**
- **Insulated Glass Unit Depth = 1"**
- **Double Strength Tempered Glass Panes**
 - *With Soft Coat Low-E & Argon*
- **Adjustable Steel Tandem Rollers**
 - *Provides effortless & quiet operation*
- **Double Weatherstripping**
 - *Prevents Air & Water Infiltration*
- **Fully Interlocked Meeting Rails**
 - *Ensures an air-tight seal*
- **High Ratio of Glass-to-Frame Area**
 - *Opens your view of the outdoors*
- **Fibermesh Locking Screen**

Options

- **Extruded Beige Color**
- **Painted Exterior Custom Color**
- **Triple Glazed Insulated Glass Unit**
- **Performa TCTM High Performance Low-E Upgrade**
- **Duralite[®] Spacer**
- **Between the Glass Grids or Exterior Applied Grids**

PRODUCT SPECS	SERIES	STYLES	FRAME DEPTH	IG DEPTH	AAMA RATING	AIR (cfm/ft ²)	WATER (psf)	UNIFORM LOAD (psf)	WALL THICKNESS (frame/sill)
	1500	Patio Sliding Door	4 ⁵ / ₈ "	1"	SGD-R35	< 0.30	5	52	0.080

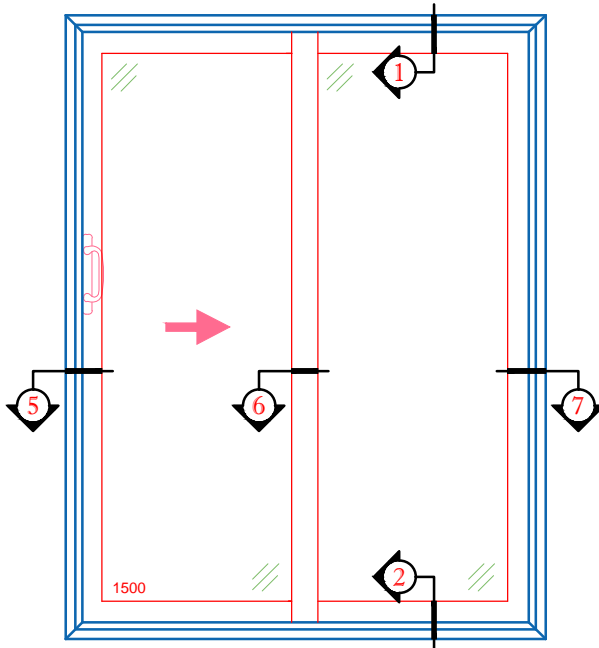

1500 X-O SLIDING DOOR

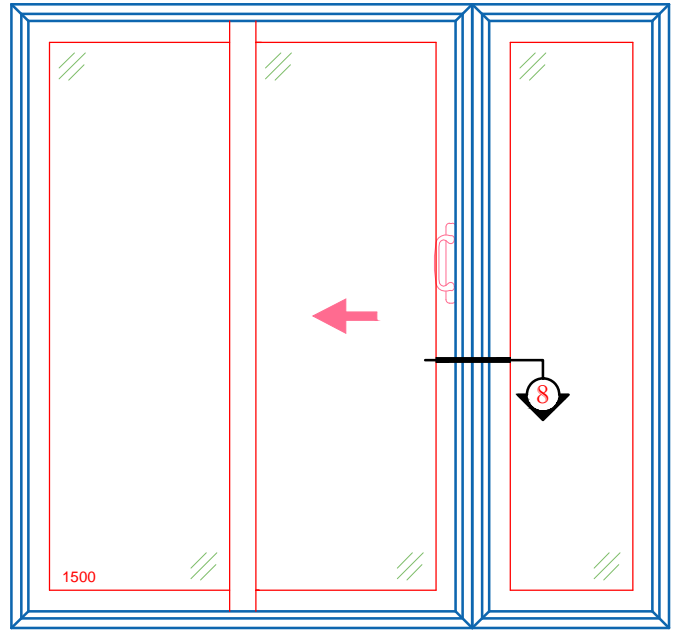

1500 O-X SLIDING DOOR WITH SIDE LITE

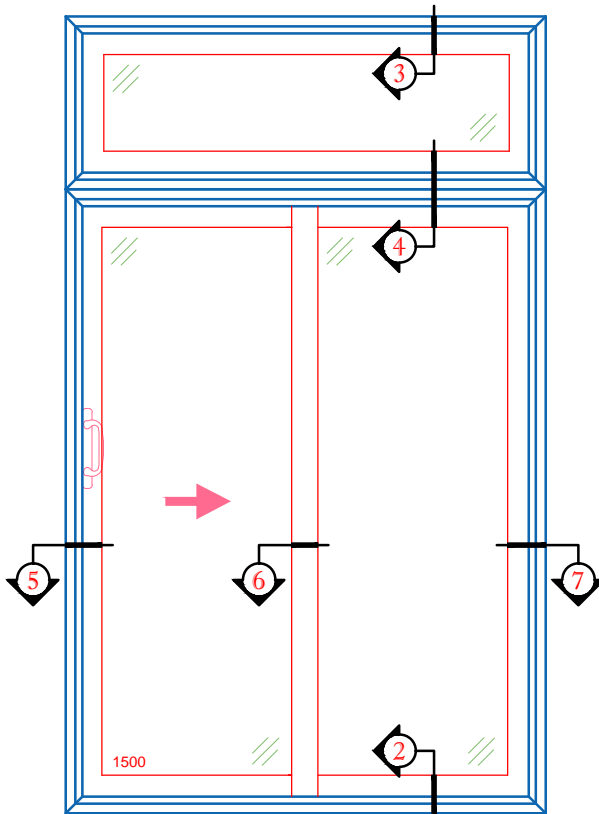

1500 X-O SLIDING DOOR W/ TRANSOM

FEATURES

- 4-5/8" FRAME DEPTH
- 1" INSULATED GLASS
- DOUBLE STRENGTH TEMPERED GLASS PANES
- SOFT COAT LOW-E & ARGON
- ADJUSTABLE STEEL TANDEM ROLLERS
- DOUBLE WEATHER-STRIPPING
- FULLY INTERLOCK MEETING RAILS
- FIBERMESH LOCKING SCREEN

OPTIONAL

- BETWEEN THE GLASS & APPLIED GRID
- CUSTOM COLORS AND FINISHES
- BRASS KEY LOCK AND FOOT LOCK
- MATCHING TRANSOM / SIDE LITE AND CIRCLE-TOP UNITS

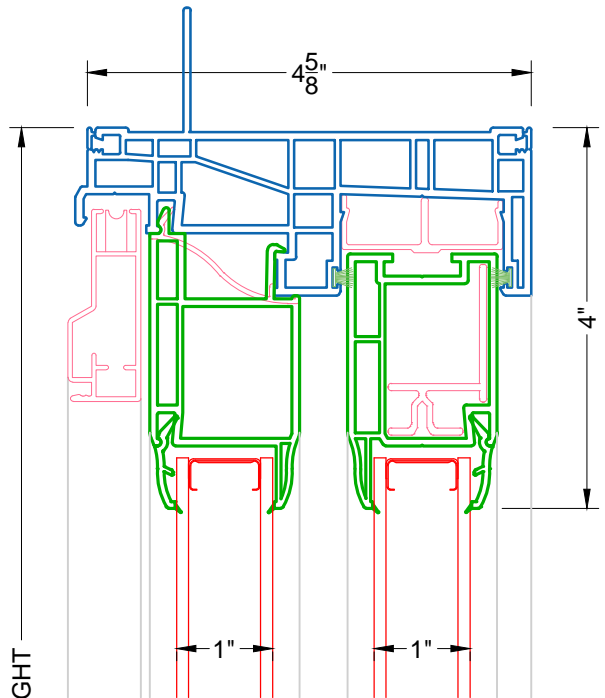

1 STANDARD HEAD
 1500 SLIDING DOOR

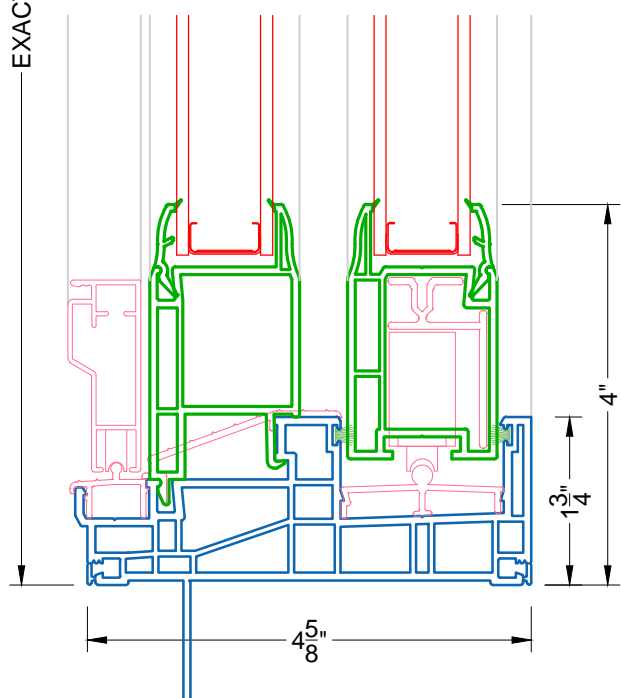

2 STANDARD SILL
 1500 SLIDING DOOR

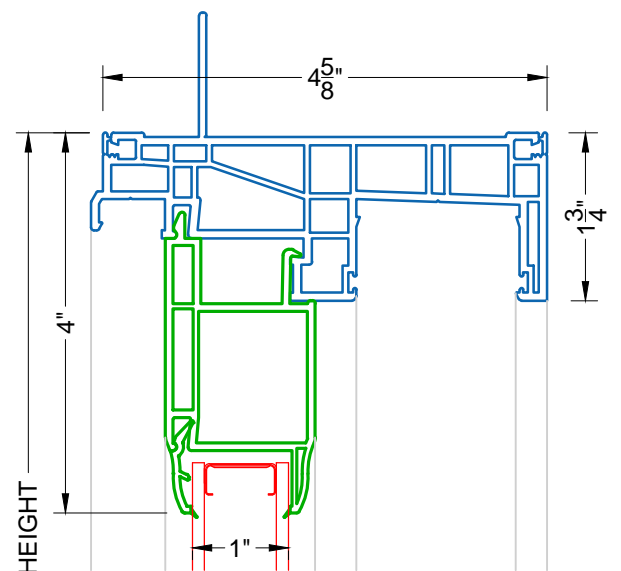

3 HEAD
 1500 TRANSOM

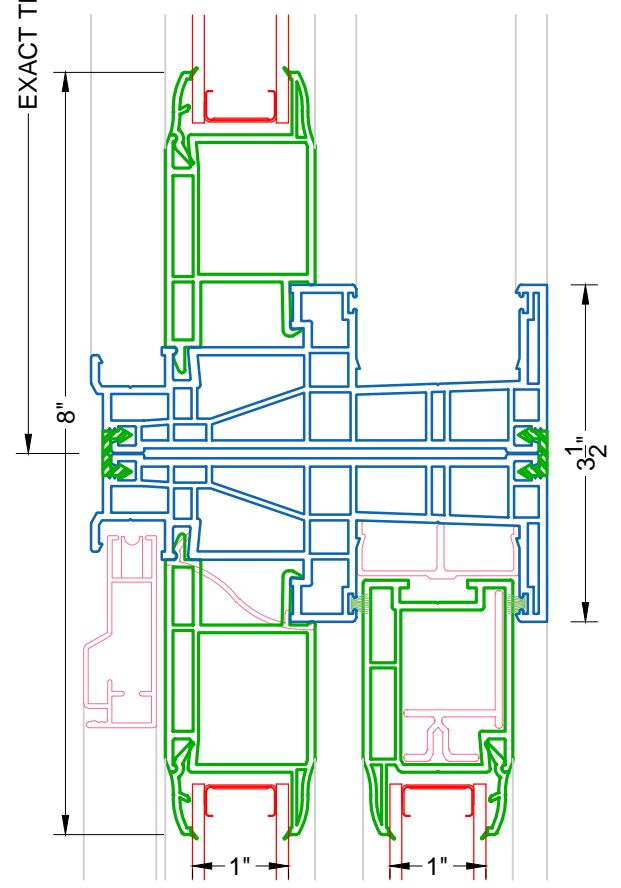

4 TRANSOM TOP
 1500 SLIDING DOOR

5 JAMB AT MOVABLE PANE
 1500 SLIDING DOOR

6 MEETING RAIL
 1500 SLIDING DOOR

7 JAMB AT FIXED PANE
 1500 SLIDING DOOR

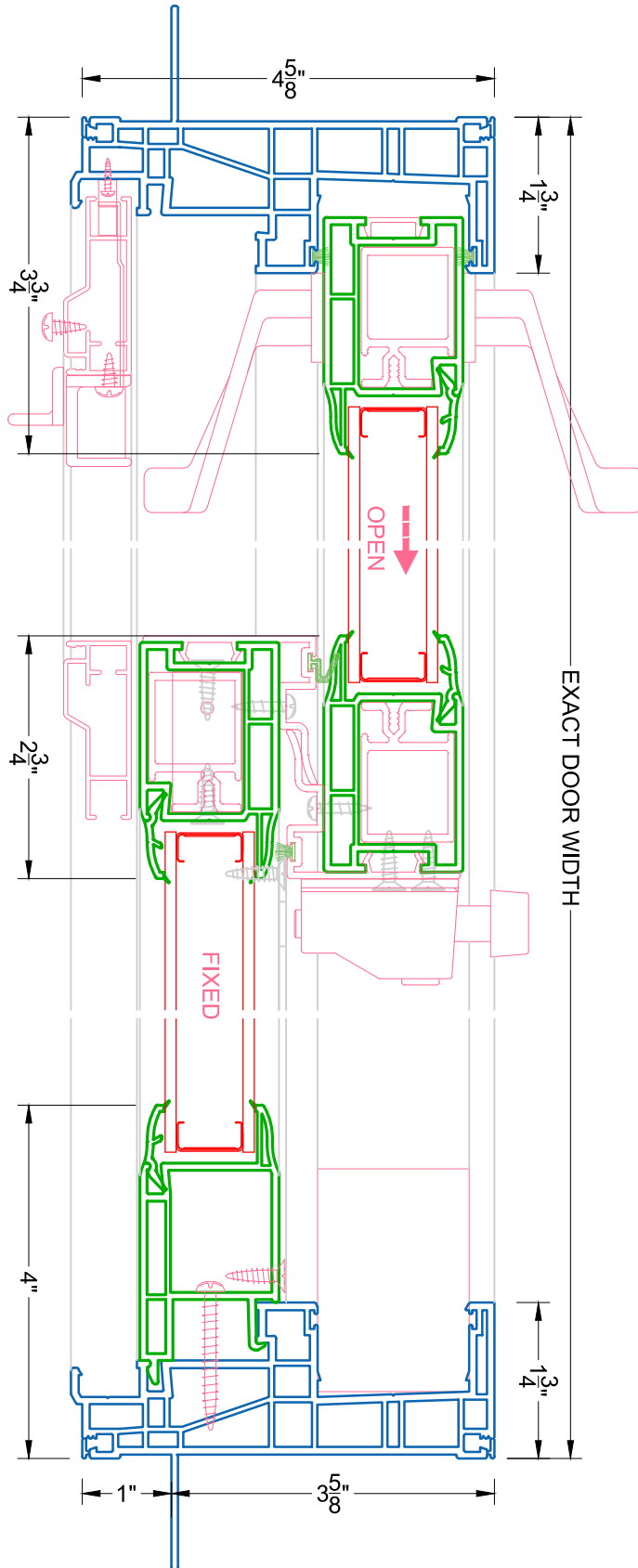

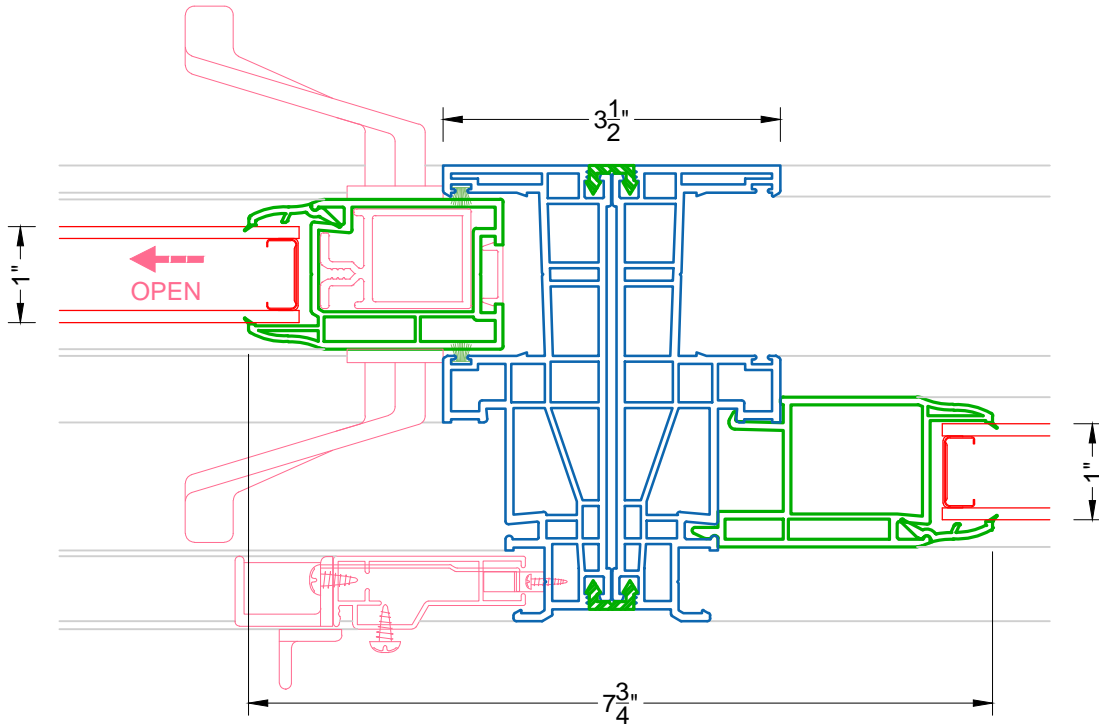

8 0 DEGREE MULLION
1500 SLIDING DOOR & SIDE LITE